

**TYPICAL INLET  
BOLT PATTERN**

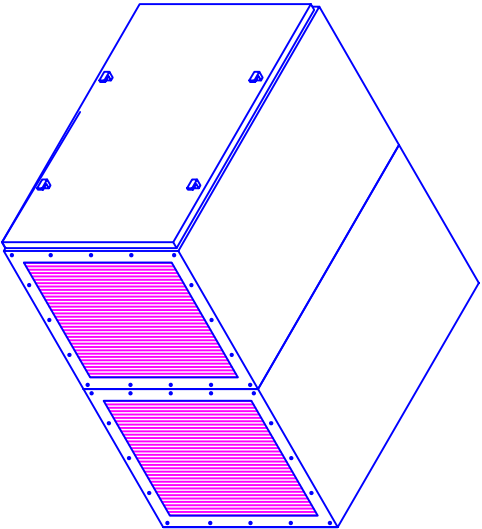

**INLET VIEW**

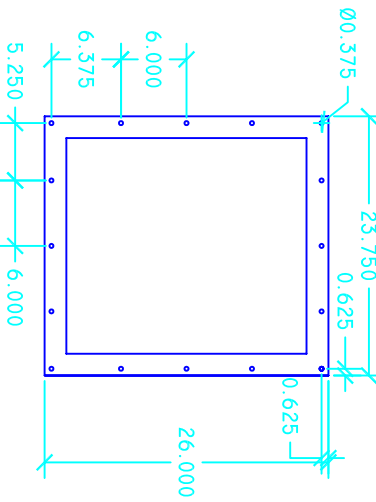
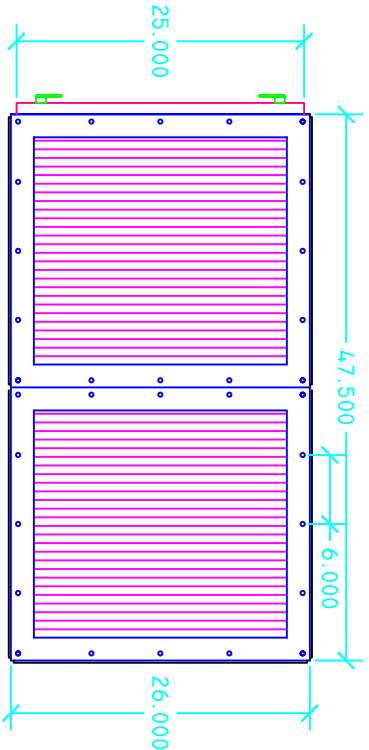

**SIDE VIEW**

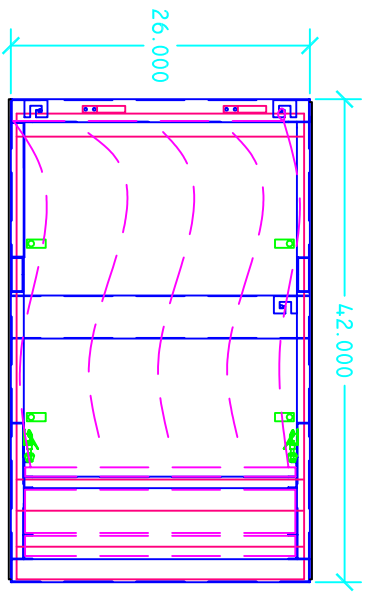

SHEET TITLE : **AZTECH M36X2**  
 DRWG. NO.: **362-081307** DRAWN BY: **TAA**  
 DATE: **08/13/07** SCALE: **NTS**

**SPECIFICATIONS:**

DIMENSIONS: 26"H X 42" W X 4.7.5" D  
 CONSTRUCTION  
 12 & 1/4 GA POWDER COATED STEEL  
 FRAME, 16 GA STEEL DOOR,  
 3/16 POLYETHYLENE PANELS,  
 CAM LOCK DOOR LATCHES  
 ADJUSTABLE COMPRESSION HINGE  
 4-WAY ALUMINUM EXHAUST GRILLE  
 QUICK RELEASE FILTER CLAMPS

STD. FILTERS: (2) 4" PLEATED PREFILTERS  
 (2) 95% BAG FILTERS

OPTIONAL FILTERS: 65% BAG FILTER,  
 26 LB CARBON MODULE  
 2" AL. MESH PREFILTER  
 2" BAFFLED PREFILTER  
 4" MIST ELIMINATOR  
 2" POLY PAD  
 99.97% HEPA AFTERFILTER

OPTIONS:  
 EYEBOLTS (INSTALLED)  
 SILENCER  
 MAGNETIC PRESSURE GAUGE  
 MANOMETER  
 SOURCE CAPTURE PLENUM  
 DUAL DOORS  
 FULL CARBON STEEL CONST.

WEIGHT: 305 LBS. (STD)

**COPYRIGHT: THIS DOCUMENT AND THE INFO-  
 RMATION CONTAINED MAY NOT BE REPRODUCED  
 OR DISTRIBUTED WITHOUT EXPRESS WRITTEN  
 CONSENT OF INDUSTRIAL MAID. UNAUTHORIZED  
 REPRODUCTION, DISCLOSURE, OR MANUFACTURING  
 USE ARE PROHIBITED BY COPYRIGHT LAW.**

**Industrial Maid LLC**  
 INDUSTRIAL MAID LLC  
 351 S. 12TH RD.  
 CORTLAND, NE 68331  
 PH. (402) 798-7116  
 FAX (402) 798-7117  
 WWW.INDUSTRIAL-MAID.COM

DISTRIBUTED BY: