

SPECIFICATIONS:

DIMENSIONS: RH60-3 36.5"H X 144.7" W X 87.5" D
 RH60-4 36.5"H X 144.7" W X 112" D
 RH60-5 36.5"H X 144.7" W X 136.5" D

MOTOR: 5 HP 208-230/46-/5/60 TEFC
 14.0-12.6/6.3 FLA

CFM: 6500 CFM @ .75" W.G.

CONSTRUCTION 1/4 & 1/8 GA POWDER COATED STEEL FRAME
 3/16 POLYETHYLENE PANELS, FULL CARBON STEEL CONSTRUCTION AVAILABLE
 4-WAY ALUMINUM EXHAUST GRILLE
 18 GA. GALV STEEL HOOD
 DUST PROOF LIGHT KIT

ELECTRICAL WIRED TO JCT. BOX

BLOWER 12X12 FORWARD CURVED BLOWER BELT DRIVEN, ADJ. SHEAVE

FILTERS: 2" ALUMINUM BAFFLE PREFILTER
 4" PLEATED PREFILTER
 95% FIBERGLASS BAG FILTER

OPTIONS: HEPA AFTER FILTER
 SILENCER
 MAGNETIC PRESSURE GAUGE
 SIDE ACCESS DOORS
 CURTAIN ENCLOSURE
 DIRECT DRIVE BI BLOWER PACKAGES

WEIGHT: RH60-3 1175 LBS.
 RH60-4 1425 LBS.
 RH60-5 1675 LBS.

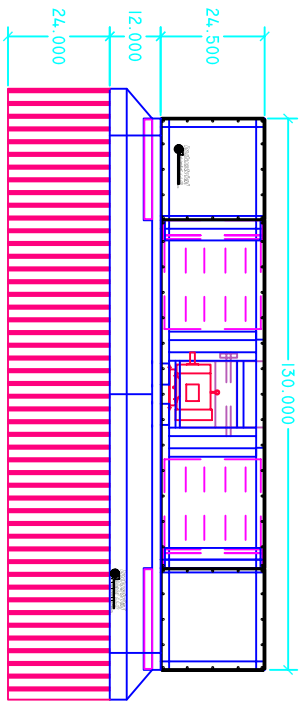
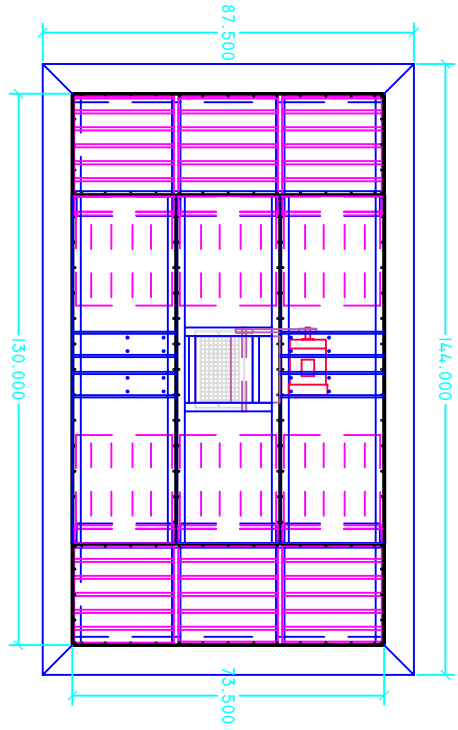
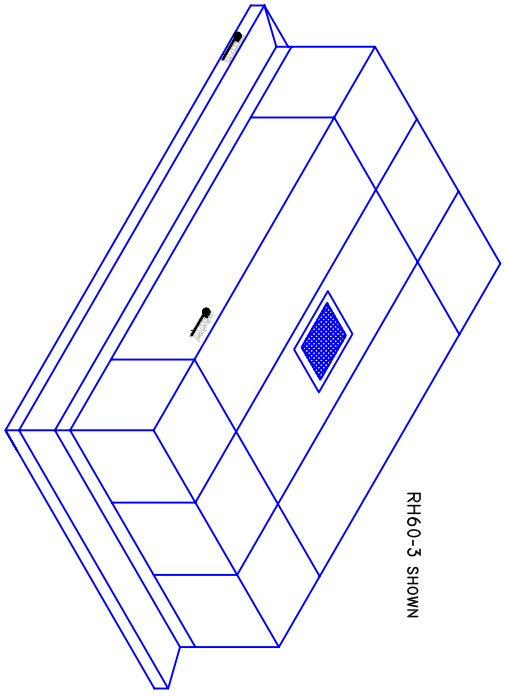
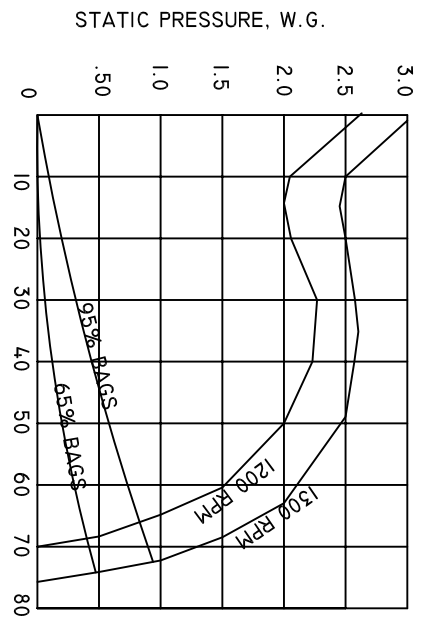

DISTRIBUTED BY:

COPYRIGHT: THIS DOCUMENT AND THE INFORMATION CONTAINED MAY NOT BE REPRODUCED OR DISTRIBUTED WITHOUT EXPRESS WRITTEN CONSENT OF INDUSTRIAL MAID. UNAUTHORIZED REPRODUCTION, DISCLOSURE, OR MANUFACTURING USE ARE PROHIBITED BY COPYRIGHT LAW.

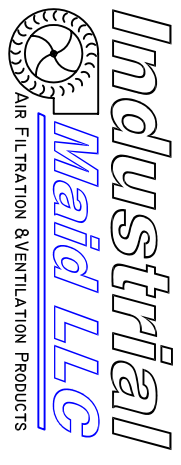

MFG. BY:
INDUSTRIAL MAID LLC
 351 S. 12TH RD.
 CORTLAND, NE 68331
 PH. (402) 798-7116
 FAX (402) 798-7117
 WWW.INDUSTRIAL-MAID.COM